

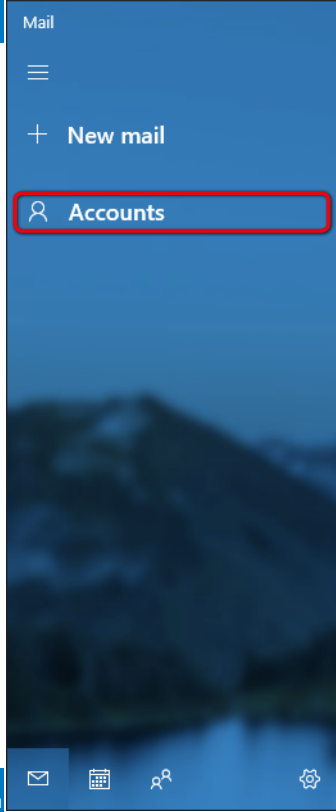

## Windows 10 Mail Configuration

As a Exchange (ActiveSync)  
mail client for reading emails.

1. Open your  
Windows 10 Mail
2. Click on  
**Accounts**



Search 



All 

3. Click on **Add account**

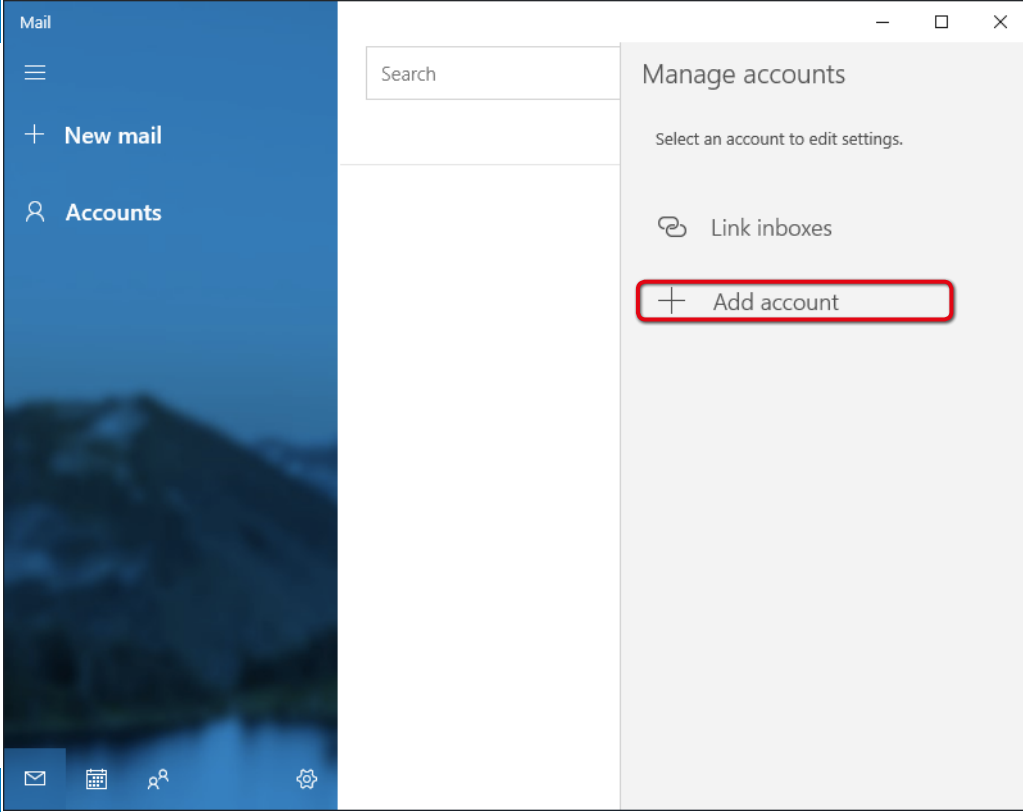

4. Click on **Advanced setup**

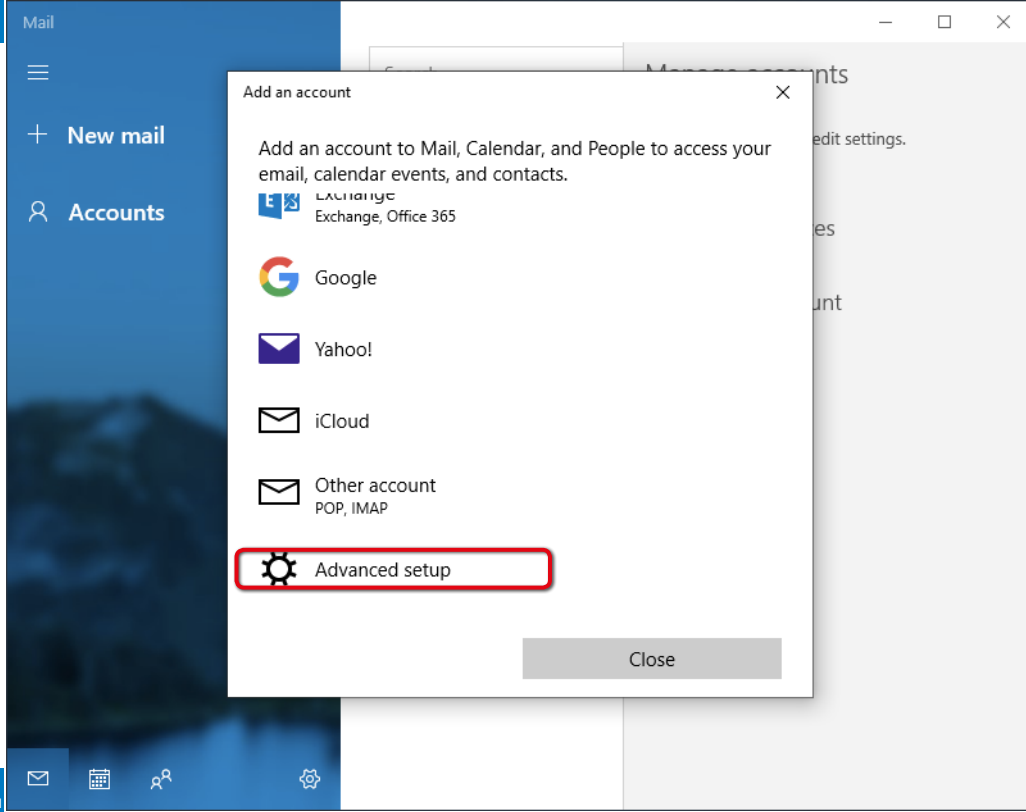

5. Click on **Exchange ActiveSync**

Mail



+ New mail



Accounts

Add an account



### Advanced setup

Choose the kind of account you want to setup. If you're not sure, check with your service provider.

**Exchange ActiveSync**

Includes Exchange and other accounts that use Exchange ActiveSync.

**Internet email**

POP or IMAP accounts that let you view your email in a web browser.

Cancel



6. Enter:  
Email address: **Your email**  
Password: **Your password**  
User name: **Your email**

*Remark:  
the Username is always  
your Email address*

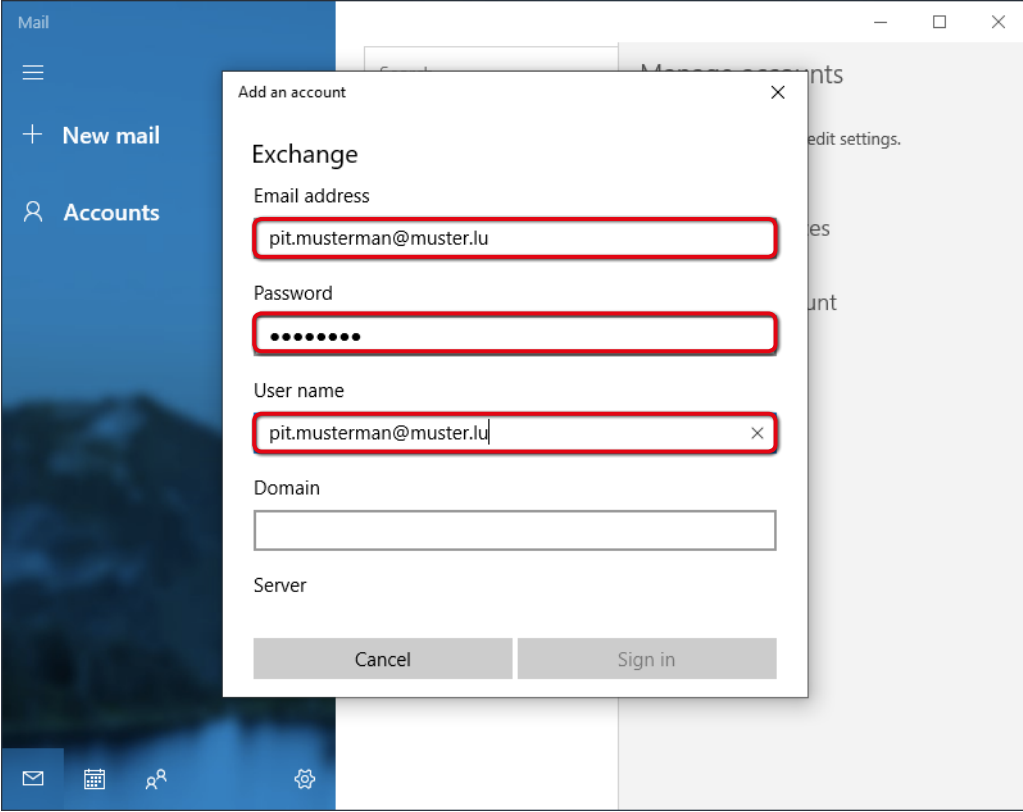

7. Enter:  
Server: **mail.mmp.lu**  
Account name: **Choose any name you want**

8. Click on „**Sign in**”

